

## **⚠️ WARNING**

To reduce the risk of drowning, entrapment, falls, paralysis, electrocution, or other serious injury or death:

**Dealer/Installer:** Give manual to homeowner.

**Installer:** Read “**Safe Installation**” on p. 2 and all instructions before beginning. For proper assembly and installation, instructions must be followed completely.

**Homeowner:** Read “**Safe Use**” on the back cover before using. Save these instructions.

Installation must comply with local codes and may require permits.

# **ENCLOSURE KIT**

Model #STEP-ENC-X for Flat-Bottom, Above-Ground Pools

## **ASSEMBLY, INSTALLATION, AND USE MANUAL**



**Scan to  
see our  
Installation  
Videos**



**MODEL  
STEP-ENC-X**

### **COMPLETE SYSTEM REQUIRES:**

- 2-STEP-1X'S
- 1-STEP-ENC-X
- 1-PES-G-X



**Full Step Enclosure System**



Made in the U.S.A. by

**CONFER**  
*plastics inc.*

[www.conferplastics.com](http://www.conferplastics.com)

# ASSEMBLY INSTRUCTIONS

## ENCLOSURE KIT MODEL #STEP-ENC-X (complete kit consists of two cartons)

PARTS LIST	HARDWARE	NEEDED FOR ASSEMBLY
<b>Qty. Description (Carton 1 of 2)</b> 1 Connecting Step 2 Connecting Rail 2 Gate Adapter Post 2 Set of Pickets (single, double, triple) <b>The following parts are supplied in the gate carton: (Carton 2 of 2)</b> 1 Gate Installation Manual 2 Gate w/hardware & padlock 1 Hinge Mounting Post 1 Latch Mounting Post	<b>Qty. Description</b> 40 #10x1-1/4" Screw 12 #10 x 3/4" Screw 12 Protective Cap	• Pliers • Mallet (or Hammer) and block of wood • Drill (cordless) • Phillips Bit • Second person to assist
Assemble the two STEP-1X units as per their instructions, but do not attach the mounting brackets to the posts (as described in Step 9). These parts will not be used. Also, do not attach the handrails to the posts (as described in Step 11 of the STEP-1X instructions). For best installation results, the outside unit should be placed on flat patio blocks on level ground.		

## Safe Installation

### **⚠ WARNING**

To reduce the risk of electrocution, drowning, entrapment, falls, or other serious injury or death:

**Check building codes/permitting.** Consult your local Building Department before installation of your pool and equipment. Pool/equipment installation must comply with the codes of the authority having jurisdiction and may require permits (e.g., building, plumbing, electrical, zoning, etc.).

#### Use for intended purpose only

- Kit and assembled product must consist of two STEP-1X's, one PES-G-X, and this enclosure kit.
- Use only as a swimming pool step system.
- This system is designed and manufactured for a specific pool wall height and/or deck of the pool - check product specification and the height of your pool.

**Check that you have all required parts.** Check the contents of the carton with the Parts list for this system. All parts and hardware are required. If any parts are missing, **DO NOT attempt to assemble or install the system.** Instead, call Toll Free U.S. - 800-635-3213 or visit our web site at [www.conferplastics.com](http://www.conferplastics.com) for assistance.

**Select an appropriate location** - The system must be located on level, solid base and in a location that will be in full view of competent adult supervision when in use.

#### Follow all instructions

- For stable, correct assembly and installation, all instructions must be followed completely and in the sequence shown.
- Follow the manufacturer's recommendations for the safe use of all hand tools and equipment used during installation.

**Cordless drill only - no corded drills near pool.** Use a cordless drill for assembly and installation. To reduce the risk of electrocution, NEVER use a corded drill in or around a pool.

**Lift safely.** When lifting awkward or heavy loads, have another person help you.

#### Double check after installation

- Before using the product, after assembly and installation, go over the instructions and procedures again to make sure nothing has been overlooked.
- Make sure that safety labels are installed and legible.

### Step 1.

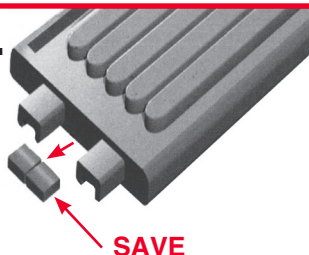

Using a pair of pliers twist off the locking wedges from both ends of the connecting step and SAVE.

### Step 2.

Lay one of the connecting rails down on a clean, flat surface. Push the end of the connecting step into the openings of the connecting rail until fully seated. Make sure the "tread" surface of the step is facing up towards the rails.

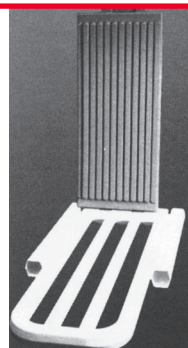

### Step 3.

Lay the second connecting rail down and push the opposite end of the connecting step into the openings until fully seated.

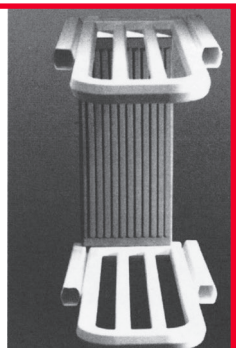

## Step 4.

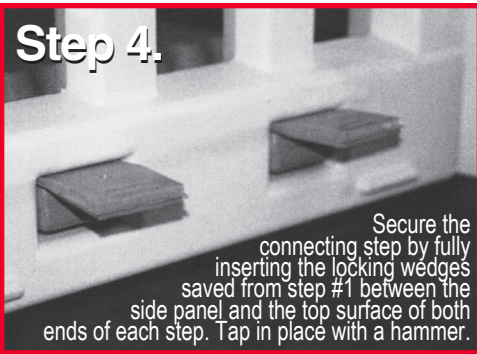

Secure the connecting step by fully inserting the locking wedges saved from step #1 between the side panel and the top surface of both ends of each step. Tap in place with a hammer.

**WARNING!** Verify that your chosen step system location is level, has a solid base, and will be in full view of competent adult supervision when in use.

**WARNING!** Pool step will be heavy. Have additional help. Do not attempt to place the step by yourself.

**WARNING!** Do not stand on the top steps of the unit until fully assembled as it may tip.

## Step 5.

With one of the assembled step units at the desired location inside the pool, and the second unit placed outside the pool, slide the assembled connector kit down over the upper handrail posts until it is resting on the pool top seat.

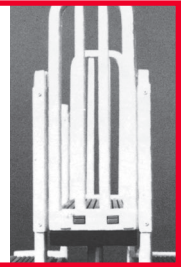

## Step 6.

With a cordless drill fasten the connector kit to the handrail posts using (16) #10 x 1-1/4" screws (eight per side) at each of the pre-marked locations.



## Step 7.

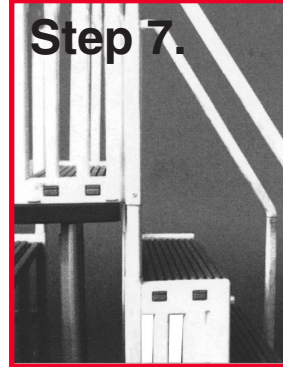

Attach the handrails to the inside unit only as described in step 11 of the STEP-1X instructions.

## Step 8.

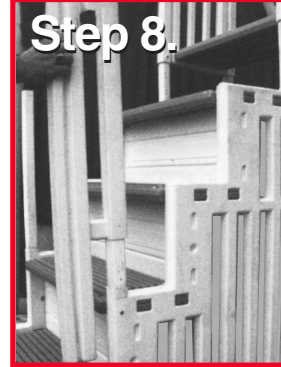

Slide the gate adapter posts down over the short handrail posts of the outside unit until they bottom out.

**WARNING!** Using a corded drill near pool may result in electrocution.

## Step 9.



Insert the ends of the notched handrails into the open ends of the posts on the outside unit. Fasten in place using four #10 x 1-1/4" screws.

## Step 10.



Align one of the triple pickets into the notches of the handrail at the top of the unit. Fasten the pickets in place at the top of the pickets using the #10 x 3/4" screws. Continue placing and fastening the double pickets and then the single picket. Repeat for the opposite handrail. Cover the ends of the screws with the protective caps.

## Step 11.

Fasten the pickets to the step unit at the pre-marked locations with twelve #10 1-1/4" screws. Also, secure the gate adapter posts and upper handrail posts in place with #10 x 1-1/4" screws at the pre-marked locations.



## Step 12.

Gate installation: see instructions enclosed with gate. There are two differences for this installation. For this installation the gate posts slide over the adapter posts as shown here. And; You must also fasten the lowest corner of that flange to the step unit as shown (see photo at far right). NOTE: the hinge post must be on your right-hand side (as you are looking up the steps).

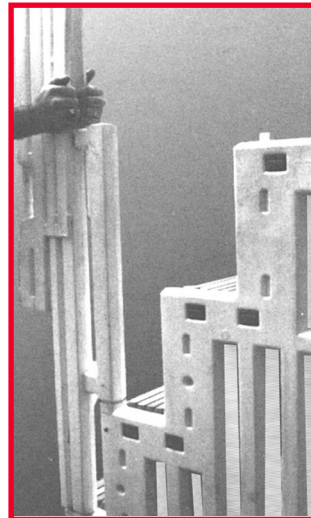

**IMPORTANT:** Fasten the lowest corner of each flange to the step as shown below.



## Safe Use

### **⚠️ WARNING**

To reduce the risk of drowning, entrapment, falls, paralysis, electrocution, or other serious injury or death:

Use step system properly.

- **No diving or jumping from steps** - shallow water; risk of paralysis or death.
- **ONE PERSON ON THE LADDER/STAIR AT A TIME.**
- Illuminate the steps when using the pool at night.

**Weight limit - 400 lbs maximum.** Exceeding maximum weight may cause the stairs to fail.

**Secure stairs when not in use.** When pool is not in use, make sure gate is closed and locked.

**Watch children at all times** when they are in or around water to help prevent drowning.

### WINTERIZING / REMOVING STEP FROM POOL

PLAN AHEAD - PEOPLE WILL HAVE TO GET IN THE POOL TO MOVE OR REMOVE THE STEP.

When winterizing your pool, if you decide to leave the pool step in the pool be sure to detach the step from the pool deck and move the step towards the center of the pool and away from the pool wall. Remove any outside steps or ladders from the pool area to eliminate access to the pool.

If you decide to remove your pool step from the pool:

### **⚠️ WARNING**

Pool step will be heavy and must be lifted from within the pool. Have additional help if you move the step or choose to remove it from swimming pool. Do not attempt to do this by yourself - 2-3 people are required to move pool step safely. DO NOT lift pool step by handrails or handrail posts - they may detach, possibly resulting in a fall.

Remove any outside steps or ladders from the pool area to eliminate access to the pool.

**DO NOT LIFT STEP BY HANDRAILS, POSTS OR TOP TREAD. THE HANDRAILS, POSTS AND TOP TREAD WILL NOT SUPPORT THE WEIGHT OF THE POOL STEP AND MAY DETACH OR BREAK, RESULTING IN A FALL OR INJURY.**

Lift up the unit inside the pool and tilt it so that the water drains out of the steps. Once it is light enough carefully lift it over the side of the pool, lay the unit on its back side and allow most of the water to drain from the side panels.

The Confer-Step can be covered, if desired, and stored outdoors.

## CONFER PLASTICS INC. FIVE YEAR WARRANTY

Confer Plastics Inc. warrants their swimming pool ladders and steps to be free from defects in workmanship for five years from date of purchase.

### **DO NOT RETURN DEFECTIVE PART TO DEALER**

E-MAIL CONFER PLASTICS AT: [LADDERS@CONFERPLASTICS.COM](mailto:LADDERS@CONFERPLASTICS.COM)

A PICTURE [S] OF DEFECTIVE PART, A BRIEF DESCRIPTION OF PROBLEM, PROOF OF PURCHASE AND YOUR CONTACT INFORMATION.

INFORMATION MAY ALSO BE FAXED TO CONFER PLASTICS AT: **716-694-3102** OR MAILED TO THE ADDRESS BELOW. UPON REVIEW OF THE INFORMATION YOU WILL BE NOTIFIED IF PART IS COVERED UNDER THE WARRANTY AND THE SHIPPING/HANDLING CHARGES.

This warranty gives you specific legal rights, and you may also have other rights which may vary from state to state.

Confer Plastics Inc.

97 Witmer Road

North Tonawanda, N.Y. 14120-2421

**MADE IN THE U.S.A. by:**



**CONFER**  
*plastics inc.*

Printed in U.S.A.

97 Witmer Road

North Tonawanda, New York 14120-2421

Toll Free U.S. 800-635-3213

716-694-3100

[www.conferplastics.com](http://www.conferplastics.com)