

**StarWhite™**  
For Above Ground Pools

**StarBright™**  
For Above Ground Pools

# ABOVE GROUND WATER RETURN LIGHT

## USER MANUAL AND INSTALLATION GUIDE

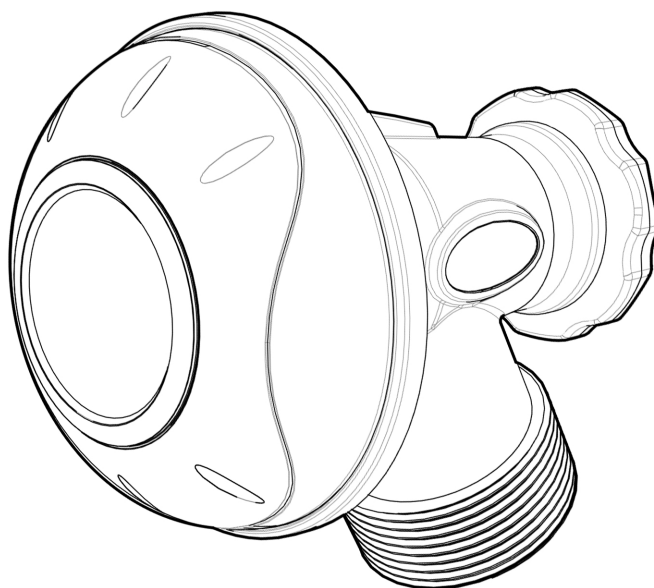
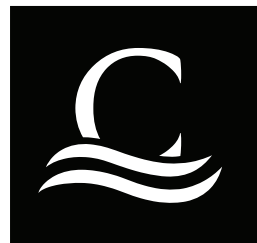

## TABLE OF CONTENTS

INTRODUCTION	2
INSTRUCTIONS	3
WATER LEVEL	3
ASSEMBLY	3
STARWHITE™ ROCKER SWITCH	4
STARBRIGHT™ REMOTE CONTROL	4
REMOTE CONTROL INSTRUCTIONS	4
SPECIFICATIONS	4
WINTERIZING	4
SPRING POOL OPENING	4
REPLACEMENT PARTS	5
CONSUMER INFORMATION	6
REPLACEMENT PARTS AVAILABILITY	6
WARRANTY	6
TECHNICAL SUPPORT INFORMATION	6

## INTRODUCTION

Thank you for purchasing the STARWHITE™ and or STARBRIGHT™ above ground pool light by CARVIN®

We want to help you get the best results from your new product and operate it safely. This manual contains information on how to do that; please read it carefully before installing and using the pool. If a problem should arise, or if you have any questions about your product, consult an authorized CARVIN® retailer or distributor.

All the information in this manual is based on the latest product information available at the time of publication. The manufacturer reserves the right to make changes at any time without notice and without incurring any obligation. No part of this publication may be reproduced without written permission.

## READ AND FOLLOW ALL INSTRUCTIONS

Review all instructions provided with the product prior to its installation, startup, operation, shutdown, maintenance or winterizing.

Failure to follow warnings and safety messages may result in property damage or personal injury. The user assumes the bodily or material risks arising from any improper use of this product.

## IMPORTANT SAFETY INSTRUCTIONS

Your safety and the safety of others are very important.

This manual provides important safety messages. A safety message alerts you to potential hazards that could hurt you or others. Each safety message is identified by a black box marked, WARNING.

**⚠ WARNING**

This manual contains important safety information which must be furnished to the end user. Failure to read and follow instructions could result in serious personal injury and/or major property damage.

**⚠ WARNING**

Install and locate this light in accordance with the installation instructions.

**⚠ WARNING**

This light is potentially hazardous if not properly installed.

**⚠ WARNING**

This light must be installed in conformance with Article 680 of the National Electric Code and all local code requirements.

**⚠ WARNING**

To reduce the risk of electric shock, a Class A ground fault circuit interrupter (GFCI) shall be installed in the branch circuit by a licensed electrician, and all devices in the system must be properly grounded. **DO NOT use extension cord sets.**

**3.** Assemble the remaining parts (5,4,7,3). Be careful to align the main body's key (1) onto the light's (5) keyway. See detail

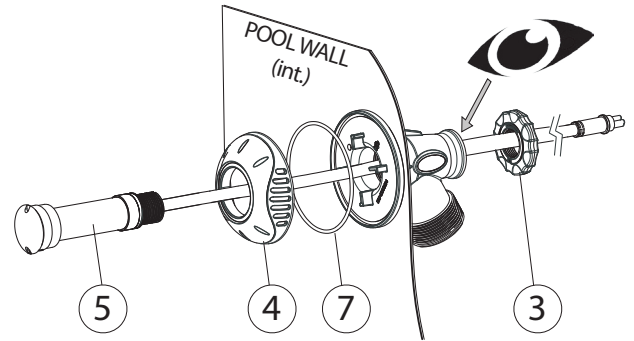

## INSTRUCTIONS

### WATER LEVEL

**1.** The water level of your pool must be at least 1 inch below the opening on your pool's wall. Disconnect the water inlet hose from the inlet fitting. Completely remove the inlet fitting. At this point, the hole on your pool wall is all that remains.

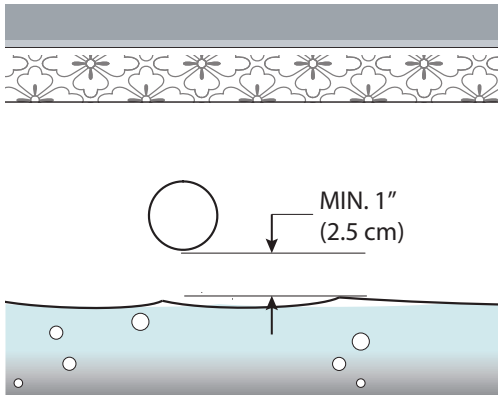

### ASSEMBLY

**2.** Screw the wall plate (2) into the main body (1) trapping a wall gaskets (6) on each side of the pool wall. Hand tighten the wall plate keeping the main body with the water inlet horizontally to the right.

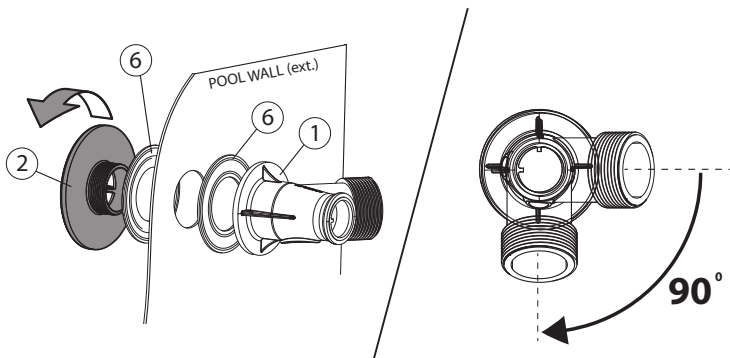

Once the wall plate (2) is tight, complete by holding the wall plate and turning the main body 90 degrees as shown.

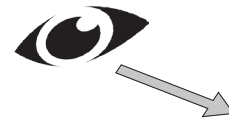

### DETAIL

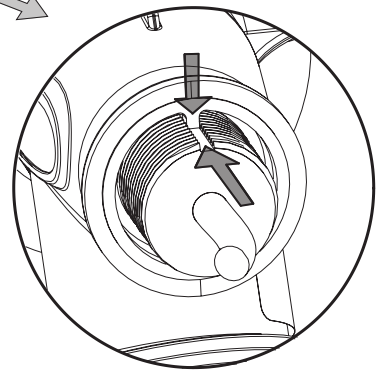

**4.** Screw the compression nut (3) **DO NOT TIGHTEN**. Position the Dome (4) to direct the water flow.

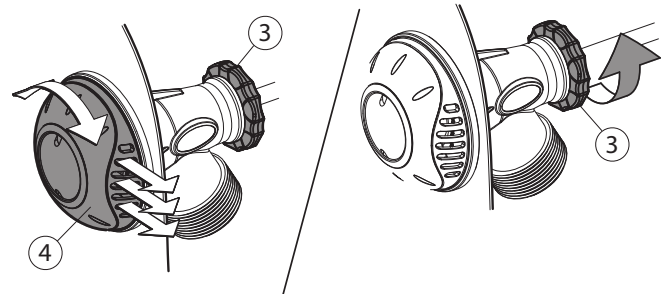

Screw the compression nut (3) until you feel a slight resistance. Complete by adding a 1/4 turn. **DO NOT OVER TIGHTEN.** The water tightness is not determined by the compression nut.

5. Choose your union (9) and screw it onto the main body (1) with the locking ring. Thread or glue, your inlet hose.

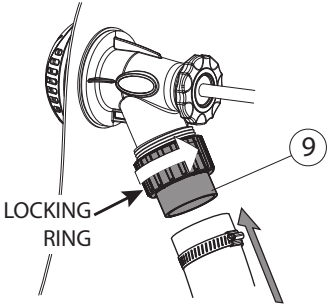

6. Raise the water level to the appropriate level for your pool.

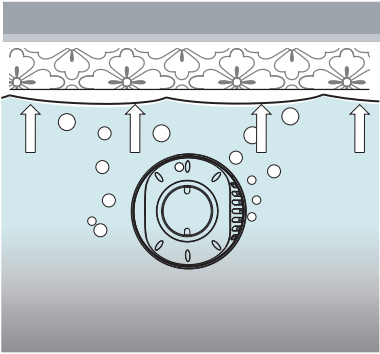

### STARWHITE™ ROCKER SWITCH

7. Install your AC adapter preferably sheltered from the elements. Connect the light to your AC adapter. Read the following instructions before connecting to power outlet.

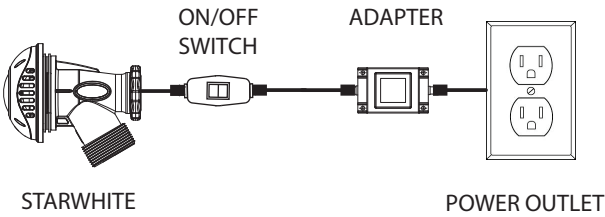

Plug the StarWhite™ wire into the switch harness, connect the harness to the AC adapter and then plug the power cord to the electrical outlet. To light up your StarWhite™ simply press the rocker switch on the cord.

### STARBRIGHT™ REMOTE CONTROL

Install your AC adapter preferably sheltered from the elements. Connect the light to your AC adapter. Read the following instructions before connecting to power outlet.

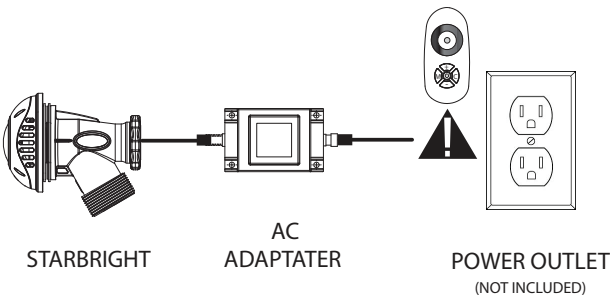

### REMOTE CONTROL INSTRUCTIONS

To pair the remote with the system for the first time, start by connecting the power adapter and controller to the power source. Within the first 5 seconds of powering on the system, press and hold both the M and C buttons on the remote simultaneously for 5 seconds while pointing it directly at the connection box. Afterward, test the remote by pressing different buttons to ensure the pairing was successful. If the remote does not respond, unplug the power source, plug it back in, and repeat the process. It may take multiple attempts to complete the pairing, so ensure you follow the steps carefully each time.

#### REMOTE CONTROL



**ON / OFF**



**MODES:** Changing between 5 different built in modes.

**M1:** Waving changing colors

**M2:** Jumping changing colors

**M3:** Fading out

**M4:** Waving changing colors + Jumping changing colors (M1 & M2)

**M5:** Gradually changing colors



**SPEED:** After pushing you can adjust the speed to which the colors will change (8 levels).



**COLORS:** Static color modes

**C1:** White color

**C2:** Color ring mode. Select the desired light color by running your finger on the color ring.



**BRIGHTNESS:** After pushing you can adjust the brightness level (8 levels).

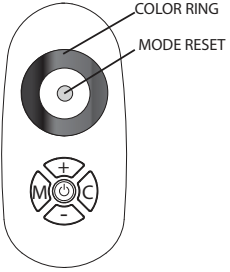

### SPECIFICATIONS

STARWHITE	VOLTAGE (V)	FREQUENCY (HZ)	TENSION (A)	WATT (W)
INPUT	120	60	5	-
OUTPUT	12	60	0.8	10

### WINTERIZING

To prevent damage to your STARWHITE™ or STARBRIGHT™, you must remove most of the assembly parts for winter. Only the main body (1), the wall plate (2) and the two wall gaskets (6) can remain. See image of step 2 for reference.

### SPRING POOL OPENING

Apply silicone grease to all your STARWHITE™ or STARBRIGHT™ O-Rings before reassembling.

# REPLACEMENT PARTS

## STARWHITE™ AND STARBRIGHT™

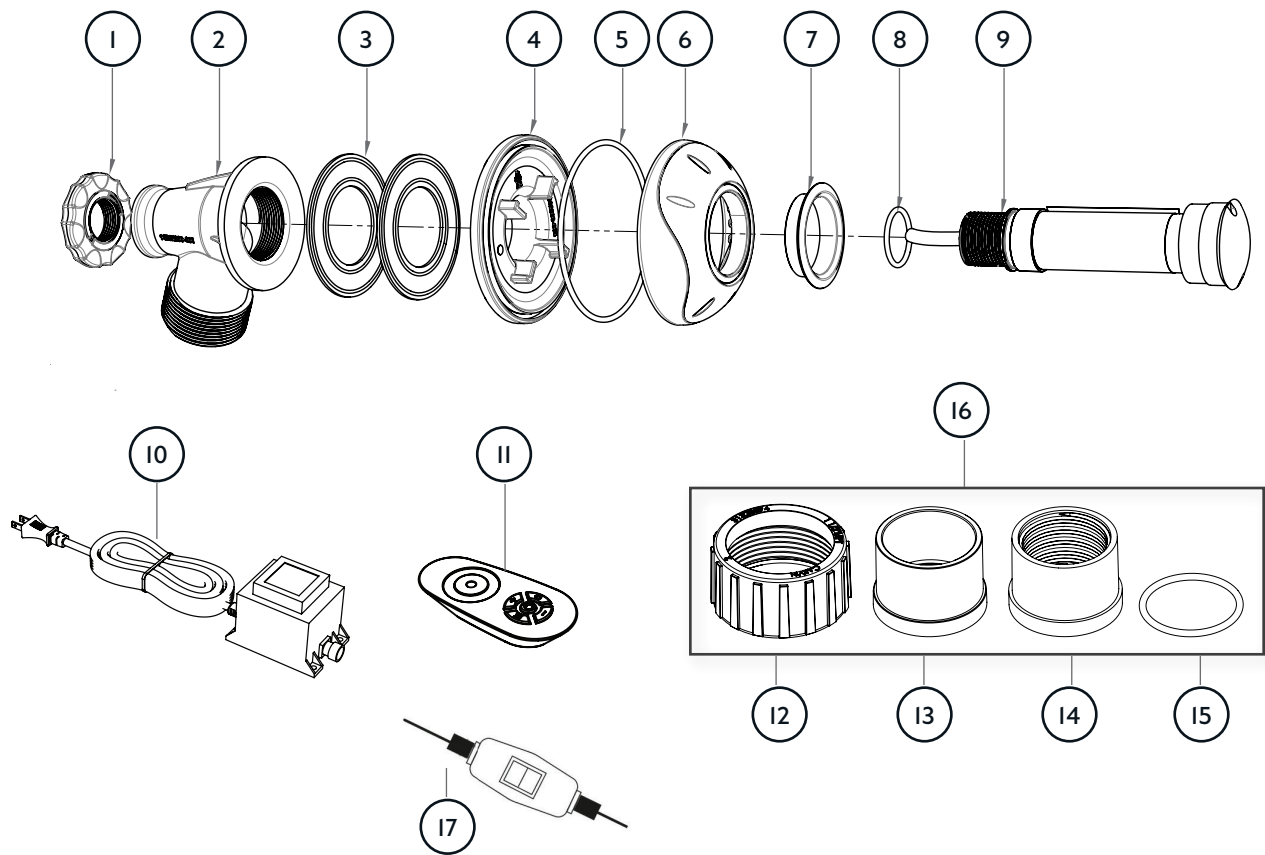

Nº	PART NO	DESCRIPTION
1	94132800003R	COMPRESSION NUT (BLUE)
	94132950130R	COMPRESSION NUT (WHITE)
	94132800003GR	COMPRESSION NUT (GRAY)
2	94132800001R	MAIN BODY
3	94132800006R	FLAT WALL GASKET (1/BAG)
	94132800006R2	FLAT WALL GASKET (2/BAG)
4	94132800002R	WALL PLATE
5	94132800007R	O-RING BIG
6	94132800004R	STARBRIGHT DOME (BLUE & WHITE)
	94132800004DGR	STARBRIGHT DOME (GRAY)
	94132950125R	STARWHITE DOME (WHITE)
	9413295012GR	STARWHITE DOME (GRAY)
7	94132800005R	RING (BLUE)
	94132950005R	RING (WHITE)
	94132800005DGR	RING (GRAY)
8	94132800008R	O-RING SMALL
9	94132800102R	LIGHT STARBRIGHT (MULTICOLOR)
	94132950100R	LIGHT STARWHITE (WHITE ONLY)
10	94132012R	AC ADAPTOR 60 HZ / 12V
11	94132070R	REMOTE CONTROL
12	31328894W	UNION NUT 2.5" MBT (WHITE OR GRAY)
13	31328898W	UNION ADAPTER 1.5" FEMALE SLIP BODY (WHITE)
14	31328895	UNION ADAPTER 1.5" FNPT THREADED (WHITE)
15	47022504	UNION ADAPTER O-RING 1 7/8 X 1/8
16	K10157	UNION NUT KIT 1.5"
17	94132950060R	CORD WITH ON/OFF SWITCH FOR STARWHITE

# CONSUMER INFORMATION

Authorized CARVIN® retailer or distributor personnel are trained professionals. They should be able to answer any question you may have. If you encounter a problem that your retailer or distributor does not solve to your satisfaction, please discuss it with the retailer's or distributor's management. The Service Manager, General Manager, or Owner can help. Almost all problems are solved in this way.

If you are not satisfied with the decision made by the retailer's or distributor's management, contact the CARVIN® technical support.

When you write or call, please provide the following information:

- Product model, serial number and date code.
- Name of retailer or distributor who sold the Product to you.
- The original proof of purchase showing the date of purchase.
- Your name, address and telephone number.
- A detailed description of the problem.
- If sending an email, any relevant photos of the Product and its surroundings.

## REPLACEMENT PARTS AVAILABILITY

Replacement parts are available through your CARVIN® retailer or distributor.

## WARRANTY

A digital warranty is provided for your product.

[https://carvinpool.com/link\\_warranty](https://carvinpool.com/link_warranty)

## TECHNICAL SUPPORT INFORMATION

After contacting your dealer or distributor, if you have any problems with your Product, contact CARVIN® Technical Support.

### AMERICA

Web: [carvinpool.com/support](https://carvinpool.com/support)

Email: [help@carvinpool.com](mailto:help@carvinpool.com)

Phone: 1 (450) 250-4500 option 2

Fax: 1 (450) 250-4501

Toll Free: 1 866 979-4501

Mail: CARVIN® POOL EQUIPMENT

#### Technical Support

4000 boul. Casavant West,  
Saint-Hyacinthe, Quebec, Canada, J2S 9E3



## LE GROUPE VIF INC.

4000, boulevard Casavant West, Saint-Hyacinthe  
Quebec, Canada, J2S 9E3

**[www.carvinpool.com](https://www.carvinpool.com)**

CARVIN® is a registered trademark of Le Groupe VIF Inc.

In Canada and the United States of America.

